



**TESA**  
TECHNOLOGY

FLYER

# DIALTRONIC lever-type dial test indicator

ELECTRONIC LEVER-TYPE DIAL TEST INDICATOR



All the advantages of a mechanical lever-type dial test indicator with digital readout

## DIALTRONIC electronic lever-type dial test indicator

Essential instruments for workshops and measurement laboratories. They can be used for comparative measurements on surface plates or for recording shape and position errors like axial and radial runout.

### Functions:

- Data transmission either by BLUETOOTH® or cable
- Data output by means of a RS232 cable
- External power supply cable
- Dynamic Min / Max / Max-Min measurement
- Automatic or manual switch-off
- Choice of resolution (0.01 or 0.001 mm)
- Selection of measuring direction
- Zeroing / Preset
- Selection mm / in
- Locking of the measured value
- Multiplication factor
- Locking of the keyboard

### Technical specifications

Measuring range (mm)	0.8
Resolution	0.001 mm / 0.00005 in
Indication error over the measurement range (Retractable and extendable plunger) MPEtot (µm)	4
Indication error over the measurement range (Retractable plunger) MPEE (µm)	3
Hysteresis of the indication error MPEH (µm)	2
Repeatability of the indication error MPER (µm)	1
Measurement force (N)	0.15
Weight (g)	70
Protection class	IP54

### Delivery content 01830004:

- Integrated® BLUETOOTH
- 1 hard metal key probe M1.4  
ø 2 mm interchangeable
- 1 key
- 1 fixing body ø 8

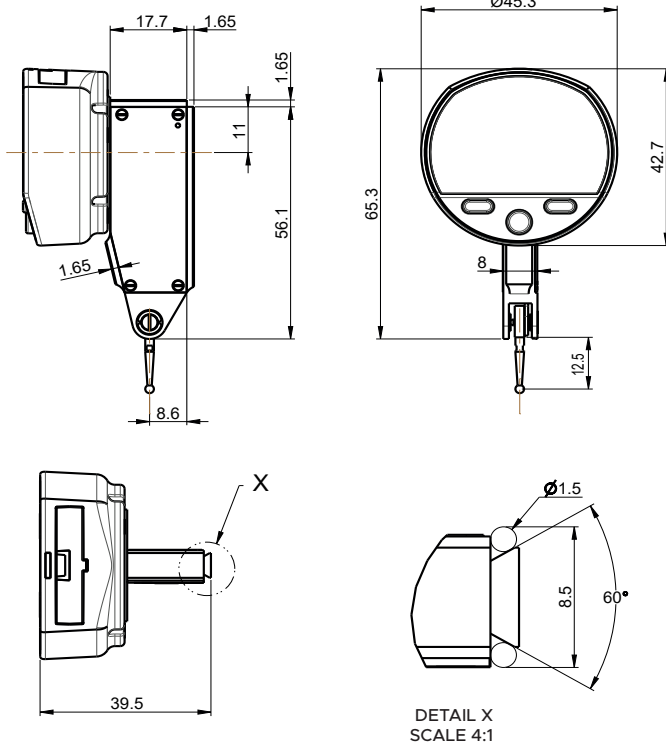

### Key features:

- BLUETOOTH® wireless data transmission
- 270° rotation of display and function keys
- Digital and analog display